

JB4 Connect Kit (Unpinned Power) Install Guide

04-13-2020

1) Open the JB4 enclosure.



2) Install the DB9 connector and ensure both screws are secure.

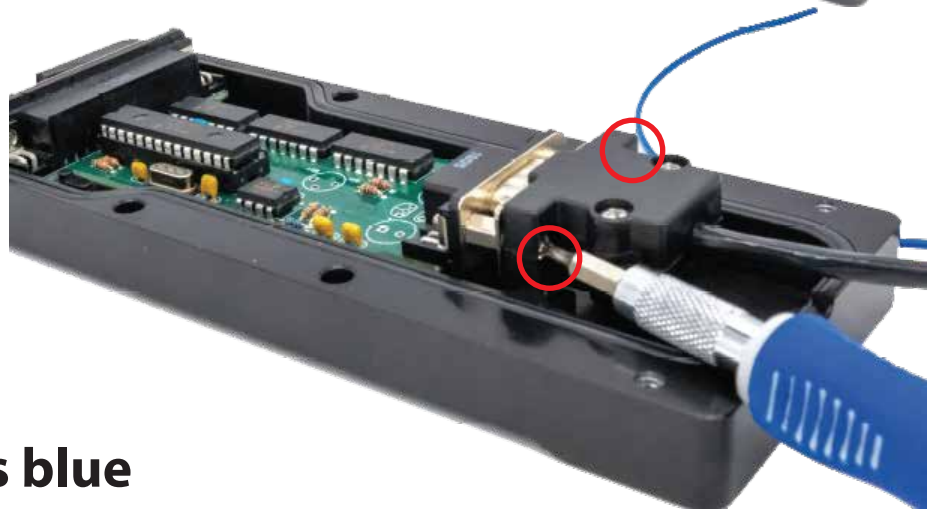

3) Insert the Connect Kit's blue wire through the rubber grommet at the JB4's DB25 connector.

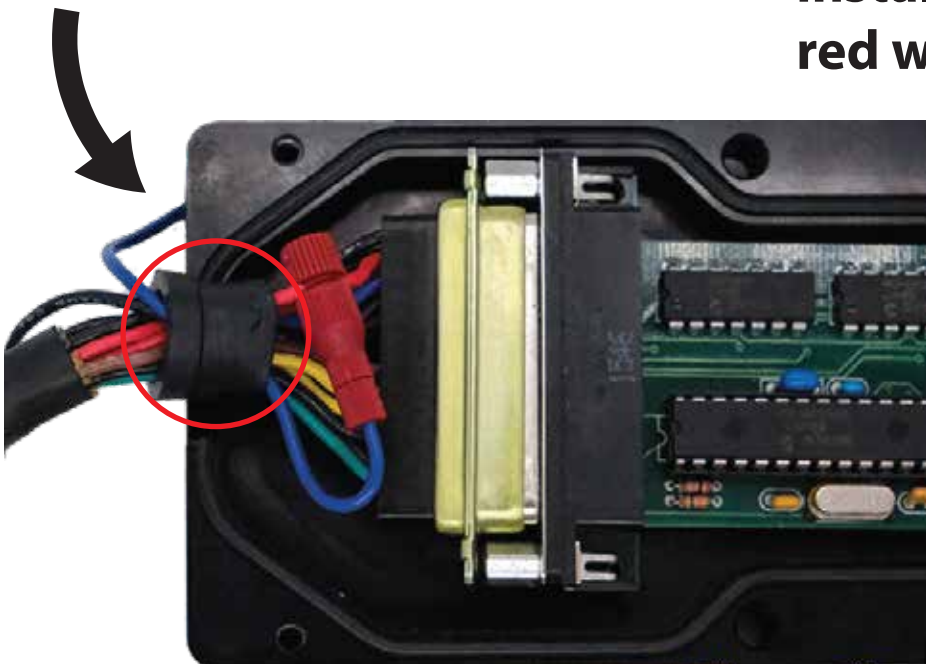

4) Using the directions below, install the Posi-Tap on either red wire in the DB25 connector.



5) Put the JB4 enclosure back together.



*****Very Important*****

6) Ensure the Connect Kit **IS NOT in direct contact with the metal JB4 enclosure or any other nearby metal. Aim the smaller side of the Connect Kit (circled below) **DIRECTLY** towards the driver's seat for best signal quality. Failure to do this may lead to connectivity issues.**

